

Using-Instructions Air eraser

EN



Art. 3843



Please read these instructions carefully to ensure the safe and effective use of this tool.

Download Bedienungsanleitung / Téléchargement du mode d'emploi / Instructions download
Descarga de la instrucción de uso / Download de instruções de operação / Download del manuale



www.KRAFTWERKtools.com

FEATURES

- Ultra-accurate concentricity
- Patented ergonomic grip handle-textured rubber grip handle helps ease user's tiredness, maintains a comfortable temperature holds and insulate vibration
- Power/Speed regulator allows for easy RPM adjustment
- Twin-Bearing design keeps spindle run smoothly

Operator's Instruction

1. Cautions for use

1-1 Air pressure

Maximum performance is displayed at the proper sanding speed, obtainable at a gauge pressure of 6.2 bar. Range-wise, this is an air pressure from 5 to 7 bar (70 to 100 psi)

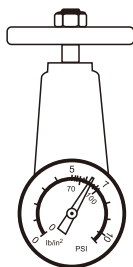

1-2 Air line

Use a 3/8" air hose between the compressor and the tool. Compressed air is cooled and its water content separated, as soon as the air leaves the compressor.

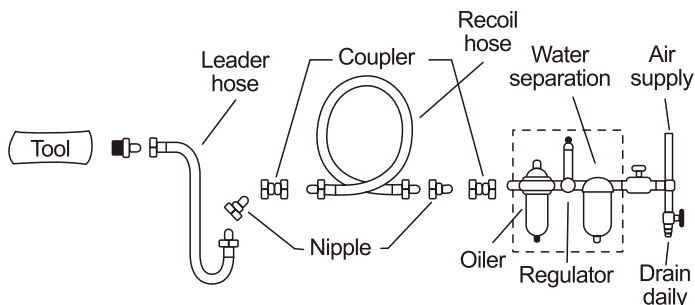

A portion of the water content, however, is condensed in the piping, and can enter the tool mechanism, and may cause trouble. So, install an air filter and an oiler between the compressor and the tool. Use a 3 HP or larger compressor for each sander.

1-3 Air hose

Clean the hose with a blast of compressed air before connecting the hose to air tool. This will prevent both moisture and dust within the hose from entering the tool and causing possible rust or malfunction. To compensate for unusually long hose (over 25 ft), the line pressure should be increased accordingly.

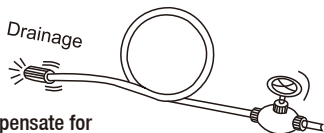

1-4

The approved eye protector, ear-muff, mouth-muffle, and gloves should be worn when operate this tool.

1-5

The working place shall be well ventilated.

1-6

Release the on-off device in the case of energy supply failure.

2. Operation, adjusting and replacing method

2-1 On-off device

To operate this tool just push the lever toward the tool itself. The tool continuously reciprocates when the lever is down. The tools stops running by releasing the lever.

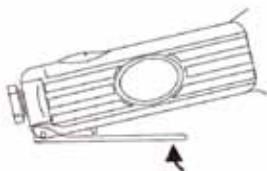

Before using the tool check the weariness of the insert tool in order to increase the efficiency and safety.

For the sake of safety, put it on hanger or on a soft flat pad when it's not in use.

2-3 Replace and adjusting

There is no user serviceable part inside this tool. Please send the tool to a qualified service center to repair or/and replace worn parts.

3. Maintenance

3-1 Lubrication

Before connecting the hose, apply 4 or 5 drops of spindle oil at the air inlet. Use of a thicker oil can lead to reduced performance or malfunction.

If a thicker oil is used by accident, wipe it away immediately. Also every 3 or 4 hours of operation, oiling is necessary.

3-2 Storage

Avoid storing the tool in a location subject to high humidity. If the tool is left as it is used, the residual moisture inside the tool can cause rust. Before storing and after operation, oil the tool at the air inlet with spindle oil and run it for a short time.

3-3 Disposal

Before disposing of damaged tool, check with your state Environmental Protection Agency to find out about special restrictions on the disposal of tool or return them to a KRAFTWERK certified service center for recycling.

3-4 Ordering service parts

For further operational and handling information or for replacement of parts and components, contact the sale agent from whom you purchased the tool or the service division of our company.

Note: In ordering parts and components, give each part number, name and quantity.

WARNING

1. This tool is not insulated for coming into contact with electric power source.
2. It is forbidden to use this tool in explosive atmospheres and do not put any combustible material near the work piece since it will emit spark, dust, and/or fumes when working in certain material.
3. Prevent long hair or loose clothing from drawing in while operate this tool.
4. Never carry the tool by hose and beware of a whipping compressed air hose.
5. The workplace shall be fixed by proper device.
6. Keep your body balance and beware of the fall of the severed workpiece.
7. When changing the socket always disconnect the air supply to avoid injuries.
8. When a job is completed turn off the air compressor and store the air tool after lubrication.
9. Excessive air pressure not only reduce the service life of this tool but also increase the danger. It is better to use the pressure regulator to control the air pressure being supplied to the tool.
10. It remains rotating for few second after releasing the lever.

Art. 3843 Air eraser

Free Speed (RPM)	2,600
Air Pressure (PSI)	90
Air Consumption (CFM)	3.5
Air Inlet (NPT,PT)	1/4"
Hose Size (INCH)	3/8"
Overall Length (INCH)	8.8" (225 mm)
Horsepower (HP)	0.45

**Test result according to EN ISO 11148-9**

Art.	Vibration	Noise	Remark
3843	EN ISO 28927-12:2012	EN ISO 15744:2008	Should wear an approved ear protector while operating this tool
		Sound Pressure level 88 dB	
	No-load: <0.1 m/s ²	Sound power level 90 dB	
		Instantaneous sound Pressure 111 dB	

Art. 3843

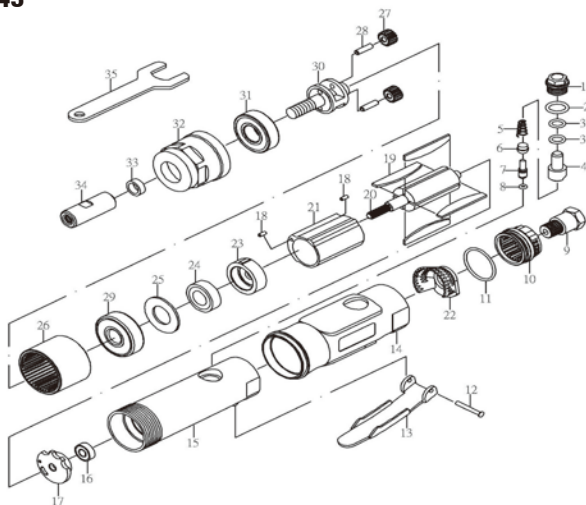

NO	Art.	Description	Qty
01	3841-01	SCREW	1
02	3840-02	O-RING (P12)	1
03	3840-03	O-RING (P8)	2
04	3841-04	AIR REGULATOR	1
05	3840-05	SPRING	1
06	3840-06	VALVE STEM BUSHING	1
07	3843-07	VALVE STEM	1
08	3840-08	O-RING (3.5 x 1.4)	1
09	3840-09	AIR INLET	1
10	3841-10	EXHAUST SLEEVE	1
11	3841-11	O-RING (26.7 x 1.78)	1
12	3840-12	SPRING PIN	1
13	3840-13	LEVER	1
14	3841-14	PROTECTING RUBBER	1
15	3841-15	HOUSING	1
16	3840-16	BEARING (696ZZ)	1
17	3841-17	REAR PLATE	1
18	3841-18	PIN	2

NO	Art.	Description	Qty
19	3841-19	ROTOR BLADE	4
20	3843-20	ROTOR (6T)	1
21	3841-21	CYLINDER	1
22	3841-22	CONE MUFFLER	1
23	3843-23	FRONT PLATE	1
24	3840-25	BEARING (608ZZ)	1
25	3843-25	WASHER	1
26	3843-26	GEAR LINK (42T)	1
27	3843-27	GEAR	2
28	3843-28	IDLE GEAR PIN	2
29	3843-29	BEARING (6001Z)	1
30	3843-30	GEAR PLATE	1
31	3843-31	BEARING (6200ZZ)	1
32	3843-32	CLAMP NUT	1
33	3843-33	WASHER	1
34	3843-34	SHAFY	1
35	3840-31	STOP SPANNER (14 mm)	1
	3843RE	ERASER DISC (OPTIONAL)	

WE RESERVE THE RIGHT FOR ANY DESIGNING CHANGES TO THE PARTS AND WITHOUT ANY NOTICEMENT IN ADVANCE.



WARNING RISK OF EYE OF HEAD INJURY



WHAT COULD HAPPEN	HOW TO PREVENT IT
Air powered equipment and power tools are capable of propelling materials such as fasteners, metal chips, sawdust and other debris at high speed which could result in serious eye injury.	Always wear ANSI approved Z87.1 safety glasses with side shields. Never leave operating tool unattached. Disconnect air hose when tool is not in use.
Compressed air can be hazardous. The air system can cause injury to soft tissue areas such as eyes, ears, etc. Particles or objects propelled by the stream can cause injury.	For additional protection use an approved face shield in addition to safety glasses.
Tool attachments can become loose or break and fly apart propelling articles at the operator and others in the work area.	Make sure that any attachments are securely assembled.



WARNING RISK OF FIRE OR EXPLOSION



WHAT COULD HAPPEN	HOW TO PREVENT IT
Abrasive tools such as sanders and grinders, rotating tools such as drills, and impact tools such as nailers, staplers, wrenches, hammers and reciprocating saws are capable of generating sparks, which could result in ignition of flammable materials.	Never operate tools near flammable substances such as gasoline, naphtha, cleaning solvents, etc. Work in a clean, well-ventilated area free of combustible materials. Never use oxygen, carbon dioxide or other bottled gases as a power source for air tools.
Exceeding the maximum pressure rating of tools or accessories could cause an explosion resulting in serious injury.	Use compressed air regulated to a maximum pressure at or below the rated pressure of any attachments. Never connect to an air source that is capable of exceeding 200 psi. Always verify prior to using the tools that the air source has been adjusted to the rated air pressure range.



WARNING RISK OF LOSS OF HEARING





WHAT COULD HAPPEN	HOW TO PREVENT IT
Long term exposure to noise produced from the operation of air tools can lead to permanent hearing loss.	Always wear ANSI S3.19 hearing protection.







WARNING INHALATION HAZARD



WHAT COULD HAPPEN	HOW TO PREVENT IT
Abrasive tools, such as grinders, sanders and cut-off tools generate dust and abrasive material, which can be harmful to human lungs and respiratory system.	Always wear properly fitting facemask or respirator when using such tools.
Some material such as adhesives and tar contain chemicals whose vapors could cause serious injury with prolonged exposure.	Always work in a clean, dry, well-ventilated area.

 WARNING RISK OF INJURY 	
WHAT COULD HAPPEN	HOW TO PREVENT IT
A tool left unattended, or with the air hose attached, can be activated by unauthorized persons leading to their injury or injury to others.	Remove air hose when tool is not in use and store tool in secure location away from reach of children and untrained users.
Air tools can propel fasteners or other materials throughout the work area.	Use only parts, fasteners and accessories recommended by the manufacturer. Keep work area clean and free of clutter. Keep children and others away from tool while it is in operation. Keep work area well lit.
Air tools can become activated by accident during maintenance or tool changes.	Remove air hose to lubricate or add grinding attachments, sanding discs, drills, etc. to the tool. Never carry the tool by hose. Avoid unintentional starting. Don't carry hook-up tool with finger on trigger. Only a authorized service representative should do repair servicing.
Air tools can cause the workpiece to move upon contact, leading to injury.	Use clamps or other devices to prevent movement.
Loss of control of the tool can lead to injury to self or others.	Never use tool while using drugs or alcohol. Don't overreach. Keep proper footing and balance. Keep handles dry, clean and free from oil/grease. Stay alert. Watch what you are doing. Use common sense. Do not operate tool when you are tired.
Poor quality, improper or damaged tools such as grinding wheels, chisels, sockets, drills, nailers, staplers, etc. can fly apart during operation, propelling particles throughout the work area causing serious injury.	Always use tool attachments rated for the speed of the power tool. Never use tools, which have been dropped, impacted or damaged by use. Use only impact grade sockets on an impact wrench. Do not apply excessive force to the tool ; let the tool perform the work.

 WARNING RISK OF ENTANGLEMENT 	
WHAT COULD HAPPEN	HOW TO PREVENT IT
Tools which contain moving elements, or drive other moving parts, such as grinding wheels, sockets, sanding discs, etc., can become entangled in hair, clothing, jewelry and other loose objects, resulting in severe injury.	Never wear loose fitting clothes or apparel that contains loose straps or ties, etc., which could become entangled in moving parts of the tools. Remove any jewelry, watches, identifications, bracelets, necklaces, etc., which might become caught by the tool. Keep hand away from moving parts. Tie up or cover long hair. Always wear proper fitting clothing and other safety equipment when using the tool.

 WARNING RISK OF CUT OR BURNS 	
WHAT COULD HAPPEN	HOW TO PREVENT IT
Tools that cut, shear, drill, staple, punch, chisel, etc. are capable of causing serious injury.	Keep the working part of the tool away from hands and body.

WARRANTY

We do not take responsibility for any damage caused by misuse.

CUSTOMER SERVICES

Contact your local importer of your specialized dealer to obtain address of our service department. You find our partners under **www.KRAFTWERKtools.com**



From date of purchase receipt
2 YEARS GUARANTEE
on material- or production-defects



KRAFTWERK Europe AG
Mettlenbachstrasse 23
CH-8617 Mönchaltorf
Switzerland
Tel. +41-44 949 40 50

KRAFTWERK Sàrl.
25, rue du Stade
F – 67870 Bischoffsheim
France
Tel. +33-388 48 64 50

www.KRAFTWERKtools.com