

Instruction manual

Portable hydraulic body repair kit

EN



10 T

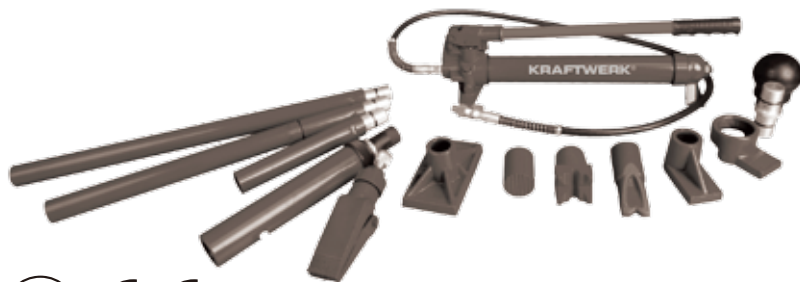

Art. 38125



Please read these instructions carefully to ensure the safe and effective use of this tool.

Download Bedienungsanleitung / Téléchargement du mode d'emploi / Instructions download
Descarga de la instrucción de uso / Download de instruções de operação / Download del manuale



www.KRAFTWERKtools.com

PRODUCT OVERVIEW

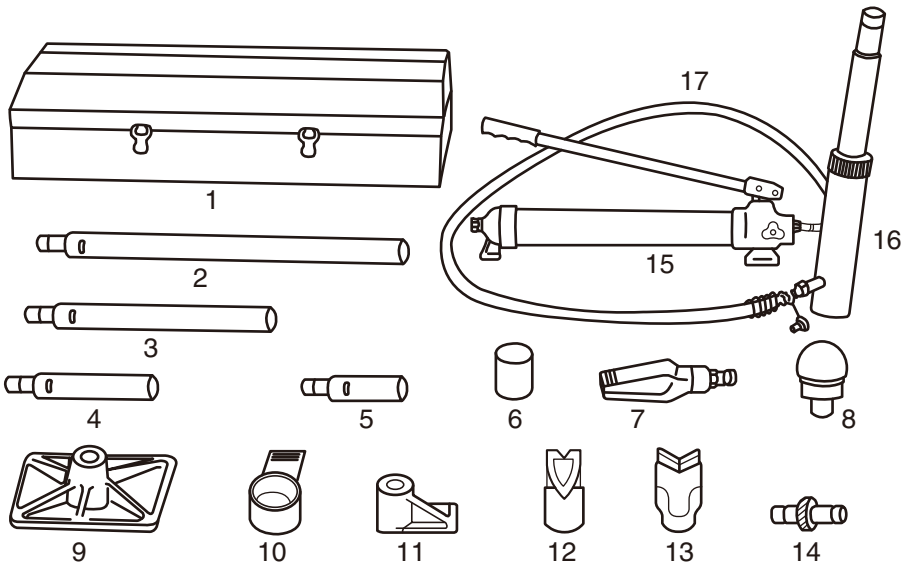

No.	Description	No.	Description
01	Case	10	Ram toe
02	Extension bar 685 mm	11	Plunger toe
03	Extension bar 456 mm	12	Cleft cap
04	Extension bar 250 mm	13	„V“ base
05	Extension bar 127 mm	14	Male connector
06	Serrated cap	15	10 T Pump unit
07	Spreading wedge	16	Ram unit
08	Big rubber head	17	Hydraulic hose
09	Base plate		

PRODUCT OVERVIEW

1. Never exceed the maximum load.
2. Never further extend the length of the lifting cylinder.
3. Always use protective caps to seal off connectors attached to accessories not being used.
4. Take care to ensure that the lifting cylinder always moves vertically in relation to the load. Should significant force be exerted when pumping, re-adjust the cylinder so that it presses down vertically on the load.
5. Do not kink the hydraulic hose or place heavy objects on it.
6. Do not use the device in the vicinity of an open fire or in a strongly heated environment.

OPERATING INSTRUCTIONS

1. Use the pump together with the lifting cylinder and ensure that all connectors are fastened correctly.
2. Close the valve by turning it clockwise.
3. Build up pressure in the pump by using the lever to make pumping movements.
4. To release the pressure on the lifting cylinder, open the valve by turning it anti-clockwise.

The pump can be used horizontally as well as vertically. When used vertically, the hydraulic hose must be pointing downwards

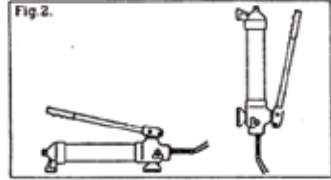
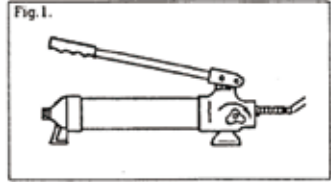

SUGGESTED SYSTEM ASSEMBLIES

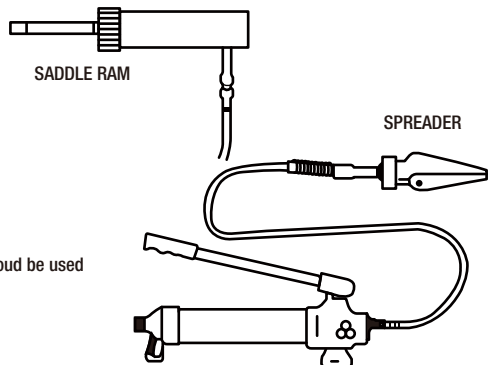
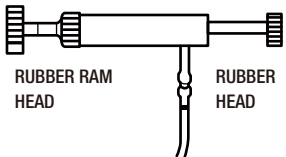
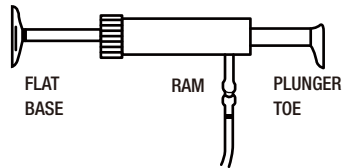
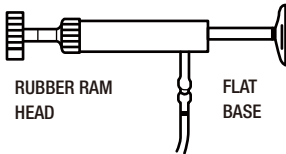
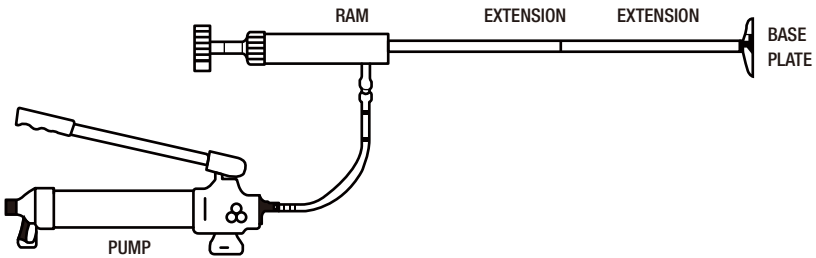

For confined areas the hydraulic spreading wedge should be used

MAINTENANCE

1. When the body repair kit is not in use, the pump unit should be stored with the release valve open.
2. To check oil level, place the pump unit in an upright position. As indicated on the diagram opposite. Remove the dip stick and the oil level will be indicated. If required add hydraulic oil until it is level with the full mark on the stem.
3. After extensive use, the oil supply should be replaced to ensure longer equipment life. To drain, remove the dip stick and open release valve. Ensure that no dirt gets into the system. Refill with approved jack oil.

IMPORTANT:

USE ONLY CERTIFIED HYDRAULIC OIL WHEN TOPPING UP AND REPLACING THE OIL.

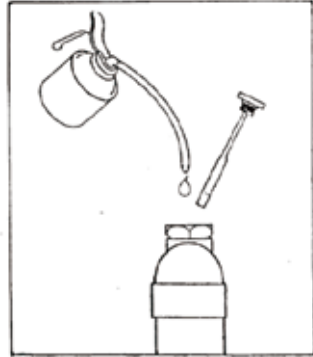

DECLARATION OF CONFORMITY

Model: **38125**

Portable hydraulic body repair kit 10 t

KRAFTWERK Sàrl, 25 rue due Stade, F-67870 Bischoffsheim

Declares under sole responsibility that the product to which this declaration relates is in conformity with the following standard(s) or other normative document(s):

EN 1494: 2000+A1/2008

Following the provisions of Directive(s)
Machinery Directive:

2006/42/EC

Bischoffsheim, 28/02/2013

Patrick Wyss
President

WARRANTY

We do not take responsibility for any damage caused by misuse or any use that is not in compliance with the safety standards described herein.

Customer services

Contact your local importer or your specialized dealer to obtain address of your service department.
You find our partners under **www.KRAFTWERKtools.com**



From date of purchase receipt
2 YEARS GUARANTEE
on material- or production-defects